



# QUARK MATTER 2015

The XXVth International Conference on  
Ultrarelativistic Nucleus-Nucleus Collisions

Sep. 27 – Oct. 3, 2015  
Kobe, Japan



2015 KOBE JAPAN

## Contents

Contacts	P. 2
Working Hours	P. 2
Network (Internet Access)	P. 2
Instructions for Presenters	P. 3
Floor Maps	P. 4 - P. 5
Time Table	P. 6 - P. 7
Schedule	
Sunday, September 27th	P. 8
Monday, September 28th	P. 9 - P. 17
Tuesday, September 29th	P. 18 - P. 29
Wednesday, September 30th	P. 26 - P. 29
Thursday, October 1st	P. 30 - P. 31
Friday, October 2nd	P. 32 - P. 33
Saturday, October 3rd	P. 34
Social Events	P. 35
Excursion	P. 35
Getting to the Banquet Place	P. 36
Train from Sannomiya Station	P. 37
Hotel Map	P. 38
Lunch	P. 39
Hospital / Clinic / Pharmacy	P. 40
ATM	P. 40
Financial Supporters	P. 41

## Contacts

### Meeting Chairs:

Hideki Hamagaki (Tokyo), chair, The University of Tokyo.  
Yasuyuki Akiba (RIKEN), co-chair, RIKEN, Nishina Center.  
Tetsuo Hatsuda (RIKEN), co-chair, RIKEN, Nishina Center.

### E-Mail Contacts:

Registration issues : [gm2015@riken.jp](mailto:gm2015@riken.jp)  
VISA issues : [gm2015Visa@riken.jp](mailto:gm2015Visa@riken.jp)  
Fellowships for young participants: [gm2015StudentSupport@riken.jp](mailto:gm2015StudentSupport@riken.jp)  
Other issues (agenda, accommodation, excursion, child care etc): [gm2015@riken.jp](mailto:gm2015@riken.jp)

### Secretariat:

The conference office is located in the Convention Room No.3 (CON3) on the 9th floor of the conference venue (Kobe Fashion Mart).

## Working Hours

Sunday, September 27th	8:30-20:30
Monday, September 28th	8:00-19:30
Tuesday, September 29th	8:30-20:30
Wednesday, September 30th	8:30-19:30
Thursday, October 1st	8:30-19:30
Friday, October 2nd	8:30-19:30
Saturday, October 3rd	8:30-14:00

## Network (Internet Access)

Wi-Fi is available on the 9th floor of the conference venue (No Wi-Fi on the street level).

SSID: QM2015

Passphrase: rokkouairando (13 characters, lowercase only)

Encryption: WPA2-AES

In case of a problem: Ask the local organizers at the conference office on the 9th floor.

Notes: Please use "http:" instead of "https:" to access the CERN-Indico except revising your INDICO page, because the proxy server cannot handle encrypted access (https:).

## Instructions for Presenters

### Plenary and parallel session talks

- Opening talk (Monday, September 28th) is allocated 40 min. plus 5 min for discussions.
- Teaser talks (Monday, September 28th) are allocated for 5 min. without discussions.
- Parallel talks (Monday, September 28th - Wednesday, September 30th) are allocated for 15 min. plus 5 min. for discussions.
- Plenary talks (Thursday, October 1st - Saturday, October 3rd) are allocated for 25 min. plus 5 min. for discussions except for the special session on "QGP in small systems?" on Friday, the 3rd plenary talk (15 min. plus 5 min.) on Saturday, and the flash talks (5 min. without discussions, maximum 3 slides) on Saturday.

**All speakers are asked to upload their talks to the INDICO conference server by the end of the day before their presentation.** Talks must be uploaded in ppt and pdf format (be mindful of proprietary fonts).

The speakers can upload and test their presentation at the conference office. The conference office is located in the Convention Room No.3 (CON3) on the 9th floor of the conference venue and is open during working hours.

### Poster presentations

- Poster session will be held in the afternoon of Tuesday, September 29th.
- **Posters must also be uploaded to the INDICO conference server before the poster session** in order to participate in the selection for flash talk presentations on Saturday, October 3rd. From the uploaded ones, some posters will be selected for presentation as 5 min. flash talk (3 slides maximum).
- The size of the poster must be A0 [84.1 cm (width) x 118.9 cm (height) = 33.11 inch (width) x 46.81 inch (height)] or smaller.

## Floor Maps of the Conference Venue (KOBE FASHION MART)

1F

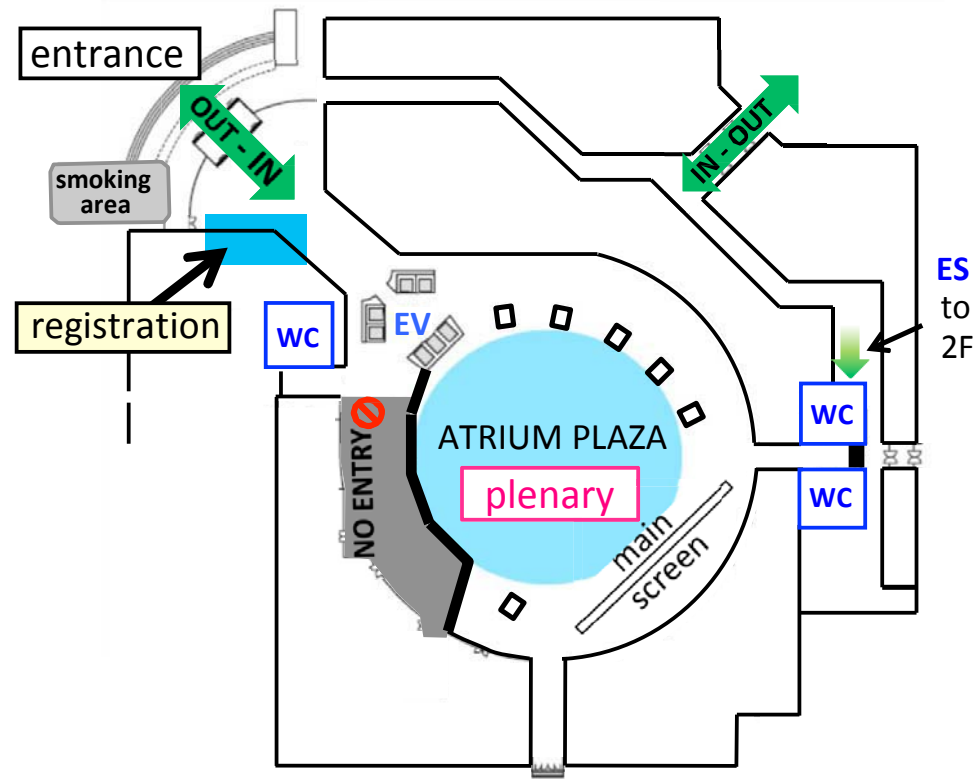

WC = Restroom  
EV = Elevator  
ES = Escalator

9F

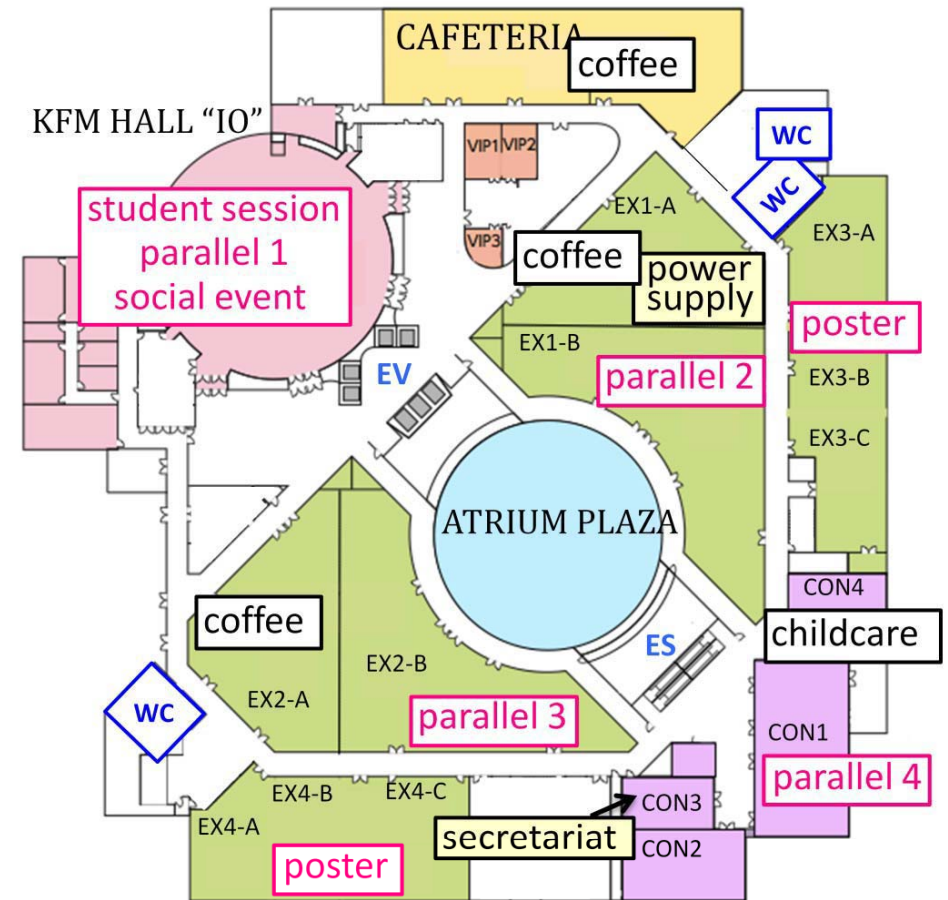

CON\* = Convention room  
EX\* = Exhibition space

Quark Matter 2015 6 Kobe, Japan

	Sun. Sep. 27 <sup>th</sup>	Mon. Sep. 28 <sup>th</sup>	Tue. Sep. 29 <sup>th</sup>
9:00		8:00-9:00 Check In	
10:00	9:00-12:15 <b>Student Session I</b> (KFM Hall “IO”, 9F) <span>p8</span>	9:00-10:40 <span>p9</span> <b>Opening Ceremony, Opening Talk, Teaser talks</b> (Atrium Plaza, 1F)	9:00-10:20 <span>p18</span> <b>Parallel Session IV</b> (9F)
11:00		Coffee break (9F)	Coffee break (9F)
12:00		11:15-12:55 <span>p10</span> <b>Parallel Session I</b> (9F)	10:50-12:30 <span>p20</span> <b>Parallel Session V</b> (9F)
13:00		12:15-13:30 Lunch (Cafeteria, 9F)	
14:00	13:30-16:45 <b>Student Session II</b> (KFM Hall “IO”, 9F) <span>p8</span>	12:55-14:30 Lunch	12:30-14:00 Lunch
15:00		14:30-16:30 <span>p12</span> <b>Parallel Session II</b> (9F)	14:00-16:20 <span>p22</span> <b>Parallel Session VI</b> (9F)
16:00			
17:00	16:30-20:00 Check In (Main entrance, 1F), Welcome Drink (Cafeteria, 9F)	Coffee break (9F)	16:30-18:30 <b>Poster Session</b> (Exhibit. space 3&4, 9F)
18:00		17:00-19:00 <span>p14</span> <b>Parallel Session III</b> (9F)	
19:00			19:00-20:00 Social event: <b>Gagaku</b> (KFM Hall “IO”, 9F)
20:00			

Wed. Sep. 30 <sup>th</sup>	Thu. Oct. 1 <sup>st</sup>	Fri. Oct. 2 <sup>nd</sup>	Sat. Oct. 3 <sup>rd</sup>
9:00-10:20 <span>p26</span> <b>Parallel Session VII</b> (9F)	9:00-10:30 <span>p30</span> <b>Plenary Session I</b> (Atrium Plaza, 1F)	9:00-10:30 <span>p32</span> <b>Plenary Session V</b> (Atrium Plaza, 1F)	9:00-10:50 <span>p34</span> <b>Plenary Session VIII</b> (Atrium Plaza, 1F)
Coffee break (9F)	Coffee break (1F&9F)	Coffee break (1F&9F)	Coffee break (1F&9F)
10:50-12:30 <span>p28</span> <b>Parallel Session VIII</b> (9F)	11:00-12:30 <span>p30</span> <b>Plenary Session II</b> (Atrium Plaza, 1F)	11:00-12:30 <span>p32</span> <b>Plenary Session VI</b> (Atrium Plaza, 1F)	11:20-12:50 <span>p34</span> <b>Flash Talks, Awards, Next QM</b> (Atrium Plaza, 1F)
12:30-18:00 <b>Excursion</b>	<b>Conference Photo</b>	12:30-14:00 Lunch	
	12:35-14:00 Lunch		
	14:00-16:00 <span>p31</span> <b>Plenary Session III</b> (Atrium Plaza, 1F)	14:00-16:00 <span>p33</span> <b>Plenary Session VII</b> (Atrium Plaza, 1F)	
	Coffee break (1F&9F)	Coffee break (1F&9F)	
	16:30-18:30 <span>p31</span> <b>Plenary Session IV</b> (Atrium Plaza, 1F)	16:30-18:30 <span>p33</span> <b>Special Session</b> (Atrium Plaza, 1F)	
20:00-22:00 <b>Conference Dinner</b> (ANA Crowne Plaza Hotel Kobe)			

9:00-16:45	<b>Student Day</b> (KFM Hall “IO”)
9:00	Theory Overview <i>Bjoern Schenke</i>
9:50	break
10:00	Study of QCD Phase Structure in High-Energy Nuclear Collisions <i>Nu Xu</i>
10:50	break
11:00	Flow <i>Jean-Yves Ollitrault</i>
11:50	Q & A session - I
12:15	Lunch (Cafeteria (9F))
13:30	QCD in heavy ion collisions <i>Kenji Fukushima</i>
14:20	break
14:30	Hard Probes of Hot Matter <i>Gunther Roland</i>
15:20	break
15:30	Experiment overview and perspectives <i>Barbara Jacak</i>
16:20	Q & A session - II
16:30-20:00	<b>Check In</b> (Information desk, Main entrance (1F))
	<b>Welcome Drink</b> (Cafeteria (9F))

8:00-9:00	<b>Check In</b> (Information desk, Main entrance (1F))
9:00-9:30	<b>Opening Ceremony</b> (Atrium plaza, chair: <i>Yasuyuki Akiba</i> )
9:00	Welcome by Hideki Hamagaki, Chair of the QM2015 Conference
9:04	Welcome by Yasuhiko Fujii, President of the Japanese Physical Society
9:09	Welcome by Kumie Inose, Vice-President of Science Council of Japan
9:14	Welcome by Kizo Hisamoto, Mayor of Kobe
9:19	Welcome by Takaharu Otsuka, Director of the Center for Nuclear Study, The University of Tokyo
9:24	Welcome by Hideto En'yo, Director of the RIKEN Nishina Center
9:29	Message by Shinzo Abe, Prime Minister of Japan (to be read by Yasuyuki Akiba, RIKEN)
9:30-10:15	<b>Opening Talk</b> (Atrium plaza, chair: <i>Yasuyuki Akiba</i> )
9:30	Ultrarelativistic heavy ion collisions: the first billion seconds <i>Gordon Baym</i>
10:15-10:40	<b>Teaser Talks</b> (Atrium plaza, chair: <i>Yasuyuki Akiba</i> )
10:15	ALICE <i>Federico Antinori</i>
10:20	ATLAS <i>Adam Trzupek</i>
10:25	CMS <i>Yen-Jie Lee</i>
10:30	PHENIX <i>David Morrison</i>
10:35	STAR <i>Frank Geurts</i>
10:40-11:15	<b>Coffee Break</b> (9F)

11:15-12:55	<b>Quarkonia I</b> Parallel (KFM Hall “IO”, chair: <i>Thomas Peitzmann</i> )	<b>New Theoretical Development I</b> (Exhibition Space 1-B, chair: <i>Chihiro Sasaki</i> )
11:15	Quarkonium production in proton-proton and proton-lead collisions with ATLAS at the LHC <i>Qipeng Hu</i>	Chiral Kinetic Theory <i>Misha Stephanov</i>
11:35	J/psi and psi(2S) production in p-Pb collisions with ALICE at the LHC <i>Marco Leoncino</i>	Chiral drag force <i>Andrey Sadofyev</i>
11:55	LHCb results from proton ion collisions <i>Zhenwei Yang</i>	Third order relativistic dissipative fluid dynamics in heavy-ion collisions and astrophysics <i>Azwinndini Muronga</i>
12:15	Cold Nuclear Matter Effects on J/psi and Upsilon production in p+Pb collisions at 5 TeV and Pb+Pb collisions at 5.1 TeV <i>Ramona Vogt</i>	Hydrodynamics with chiral anomaly and charge separation in relativistic heavy ion collisions <i>Xu-Guang Huang</i>
12:35	Forward $J/\psi$ production in pA collisions at the LHC <i>Bertrand Ducloue</i>	What flows in the chirally anomalous transport? <i>Kenji Fukushima</i>
12:55-14:30	<b>Lunch</b>	

<b>Open Heavy Flavors and Strangeness I</b> (Exhibition Space 2-B, chair: <i>Yu-Gang Ma</i> )	<b>QCD at High Temperture</b> (Convention Room 1, chair: <i>Frithjof Karsch</i> )
Identified light and strange hadron spectra at $\sqrt{s_{NN}}=14.5$ GeV and systematic study of baryon/meson effect at intermediate transverse momentum with STAR at RHIC BES I <i>James Brandenburg</i>	Recent progress in understanding gauge topology, confinement and chiral symmetry breaking <i>Rasmus Larsen</i>
Multiplicity and rapidity dependence of strangeness and multi-strangeness production in pp, pPb and PbPb at CMS <i>Hong Ni</i>	The topological structures in strongly coupled QGP with chiral fermions on the lattice <i>Sayantana Sharma</i>
$\phi$ production at forward rapidity in pp, pPb and PbPb collisions with ALICE <i>Alessandro De Falco</i>	QCD phase diagram from analytical continuation <i>Szabolcs Borsanyi</i>
Violation of mass ordering for multi-strange hadrons at RHIC and LHC <i>Shiori Takeuchi</i>	Energy loss and shear viscosity at NLO in a high-temperature QGP <i>Jacopo Ghiglieri</i>
Results from (anti-)(hyper-)nuclei production and searches for exotic bound states with ALICE at the LHC <i>Natasha Sharma</i>	Confronting fluctuations of conserved charges in central nuclear collisions at the LHC with predictions from Lattice QCD <i>Alexander Philipp Kalweit</i>
<b>Lunch</b>	

14:30-16:30 Parallel	<b>Correlations and Fluctuations I</b> (KFM Hall “IO”, chair: <i>Tapan Nayak</i> )	<b>Jets and High pT Hadrons I</b> (Exhibition Space 1-B, chair: <i>John Harris</i> )
14:30	Higher moments of net-proton and net-charge multiplicity distributions at 14.5 GeV measured in Au+Au collisions at mid-rapidity with STAR at RHIC <i>Jochen Thaefer</i>	Charged particle production in proton-lead collisions measured by the ATLAS detector <i>Evgeny Shulga</i>
14:50	Longitudinal Asymmetry and its Measurable Effects in Pb-Pb Collisions at 2.76 TeV <i>Rashmi Raniwala</i>	Decomposing energy balance contributions for quenched jets with CMS <i>Olga Evdokimov</i>
15:10	Measurement of the correlation between flow harmonics of different order in lead-lead collisions at $\sqrt{s_{NN}}=2.76$ TeV with ATLAS <i>Sooraj Krishnan Radhakrishnan</i>	Angular distributions of the quenched energy flow from dijets with different radius parameters in CMS <i>Christopher Mc Ginn</i>
15:30	Thermal blurring effects on fluctuations of conserved charges in rapidity space <i>Masayuki Asakawa</i>	Interplay between Mach cone and radial expansion in jet events <i>Yasuki Tachibana</i>
15:50	Influence of conservation laws on higher moments of the net proton and net charge distribution <i>Hannah Petersen</i>	Thermalization of mini-jets in a quark-gluon plasma <i>Bin Wu</i>

	<b>Open Heavy Flavors and Strangeness II</b> (Exhibition Space 2-B, chair: <i>Frank Geurts</i> )	<b>Initial State Physics and Approach to Equilibrium I</b> (Convention Room 1, chair: <i>Sangyong Jeon</i> )
	Charm degrees of freedom above deconfinement <i>Peter Petreczky</i>	Re-weighting at the LHC: the p-Pb data impact <i>Maria Zurita</i>
	PHENIX measurement of single electrons from charm and bottom decays at midrapidity in Au+Au collisions <i>Darren McGlinchey</i>	Charged-Particle Multiplicity Distributions over Wide Pseudorapidity Range in Proton-Proton Collisions with ALICE <i>Valentina Zaccaro</i>
	Nuclear Modification Factors of D Meson Production in Au+Au Collisions at $\sqrt{s_{NN}} = 200$ GeV <i>Guannan Xie</i>	Centrality and pseudorapidity dependence of transverse energy flow in pPb collisions at 5.02 TeV with CMS <i>Michael Murray</i>
	Measurements of heavy-flavour nuclear modification factor and elliptic flow in Pb-Pb collisions at $\sqrt{s_{NN}} = 2.76$ TeV with ALICE <i>Andrea Dubla</i>	Initial state from holography <i>Wilke van der Schee</i>
	Beauty production in heavy ion collisions with CMS <i>Jian Sun</i>	Initial state azimuthal anisotropies in small collision systems <i>Tuomas Lappi</i>



Monday, September 28<sup>th</sup> (4)

14:30-16:30 (Continued) **(Correlations and Fluctuations I)** **(Jets and High pT Hadrons I)**

16:10	Nonlinear hydrodynamic response confronts LHC data <i>Li Yan</i>	Modification of reconstructed gamma-jets in heavy-ion collisions <i>Tan Luo</i>
-------	---	--

16:30-17:00 **Coffee Break**

17:00-19:00 Parallel	<b>Correlations and Fluctuations II</b> (KFM Hall “IO”, chair: <i>Joachim Stroth</i> )	<b>Jets and High pT Hadrons II</b> (Exhibition Space 1-B, chair: <i>Francois Gelis</i> )
-------------------------	---	---

17:00	NA61/SHINE results on fluctuations and correlations in p+p and Be+Be interactions at CERN SPS energies <i>Maja Katarzyna Mackowiak-Pawlowska</i>	Fragmentation patterns of jets in pPb collisions in CMS <i>Austin Alan Baty</i>
-------	---	--

17:20	Indications for a Critical End Point in the Phase Diagram for Hot and Dense Nuclear Matter <i>Roy Lacey</i>	Exploring jet sub-structure in Pb-Pb collisions at 2.76 TeV with ALICE <i>Leticia Cunqueiro Mendez</i>
-------	--	---

Monday, September 28<sup>th</sup> (4)

**(Open Heavy Flavors and Strangeness II)** **(Initial State Physics and Approach to Equilibrium I)**

event by event correlations between light and heavy mesons <i>Joerg Aichelin</i>	Azimuthal Harmonics at RHIC and LHC energies: Competition between Initial State Bremsstrahlung and Final State Hydrodynamics <i>Peter Levai</i>
---	--

**Coffee Break**

<b>QGP in Small Systems I</b> (Exhibition Space 2-B, chair: <i>Jiangyong Jia</i> )	<b>Initial State Physics and Approach to Equilibrium II</b> (Convention Room 1, chair: <i>Federico Antinori</i> )
---	--

Direct photon production and jet quenching in small systems <i>Charles Gale</i>	Charge-dependent anisotropic flow in Cu+Au collisions <i>Takafumi Niida</i>
--	--

Flow in small systems from parton scatterings <i>Guo-Liang Ma</i>	PHENIX results on flow observables in asymmetric Cu+Au collisions <i>Brennan Schaefer</i>
--	--

17:00-19:00 (Continued) **(Correlations and Fluctuations II)** **(Jets and High pT Hadrons II)**

17:40 Systematics of higher order net-baryon number fluctuations at small values of the baryon chemical potential: A comparison of lattice QCD and beam energy scan results  
*Frithjof Karsch*

Subjet structure as a discriminating quenching probe  
*Xiaoming Zhang*

18:00 Modeling chiral criticality and its consequences for heavy ion collisions  
*Gabor Almasi*

Jet Hadronization via Recombination of Parton Showers in Vacuum and in Medium  
*Rainer Fries*

18:20 Correlated fluctuations near the QCD critical point  
*Huichao Song*

Jet-induced medium excitation in heavy-ion collisions  
*Wei Cheng*

18:40 Heavy-light flavor correlations and the QCD phase boundary  
*Chihiro Sasaki*

Consequences (and a possible explanation) of the  $R_{pA}^{\text{jet}} - R_{pA}^{\text{hadron}}$  puzzle  
*Urs Wiedemann*

**(QGP in Small Systems I)** **(Initial State Physics and Approach to Equilibrium II)**

Effects produced by multi-parton interactions and color reconnection in small systems  
*Guy Paic*

The influence of pre-equilibrium dynamics on heavy-ion collision observables  
*Ulrich Heinz*

Differential multi-particle correlation measurements for pPb collisions at CMS  
*Quan Wang*

Early Time Dynamics of Gluon Fields in High Energy Nuclear Collisions  
*Joseph Kapusta*

Light flavour results in p-Pb collisions with ALICE  
*Antonio Ortiz Velasquez*

Resumming large radiative corrections in the high-energy evolution of the Color Glass Condensate  
*Edmond Iancu*

PHENIX results on collectivity in  $^3\text{He}+\text{Au}$  collisions  
*Shengli Huang*

The non-trivial interplay of elastic and inelastic collisions in the thermalization of the quark-gluon plasma  
*Jean-Paul Blaizot*

9:00-10:20 Parallel	<b>Quarkonia II</b> (KFM Hall “IO”, chair: <i>Min Jung Kweon</i> )	<b>New Theoretical Developments II</b> (Exhibition Space 1-B, chair: <i>Teiji Kunihiro</i> )
9:00	PHENIX measurement of the collision system and multiplicity dependence of heavy quarkonia production <i>Anthony Frawley</i>	Strong-Coupling Effects in a Plasma of Confining Gluons <i>Radoslaw Ryblewski</i>
9:20	Charmonium production in Pb-Pb collisions with ALICE at the LHC <i>Hugo Denis Antonio Pereira Da Costa</i>	Matrix model of the semi-QGP with quarks <i>Robert Pisarski</i>
9:40	Upsilon production measurements in pp, p-Pb and Pb-Pb collisions with ALICE <i>Indranil Das</i>	Soft-Collinear Effective theory for hadronic and nuclear collisions: The evolution of jet quenching from RHIC to the highest LHC energies <i>Ivan Vitev</i>
10:00	In-medium quarkonium properties from a lattice QCD based effective field theory <i>Alexander Rothkopf</i>	In-medium jet evolution: interplay between broadening and decoherence effects <i>Liliana Apolinario</i>

10:20-10:50 **Coffee Break**

<b>Collective Dynamics I</b> (Exhibition Space 2-B, chair: <i>In-Kwon Yoo</i> )	<b>Open Heavy Flavors and Strangeness III</b> (Convention Room 1, chair: <i>Zaida Conesa Del Valle</i> )
Measurement of D Meson Azimuthal Anisotropy in Au+Au Collisions at $\sqrt{s_{NN}} = 200$ GeV from STAR <i>Michael Lomnitz</i>	PHENIX measurement of $b\bar{b}$ production in $p+p$ collisions <i>Abhisek Sen</i>
Beam-Energy and Centrality Dependence of Directed Flow of $\Lambda$ , $\bar{\Lambda}$ , $\phi$ , $K_s^0$ , $K^\pm$ , $p$ , $\bar{p}$ , $\pi^\pm$ <i>Prashanth Shanmuganathan</i>	Measurements of heavy-flavour production in p-Pb collisions with ALICE <i>Jeremy Wilkinson</i>
(Anti-)deuteron production and anisotropic flow measured with ALICE at the LHC <i>Ramona Lea</i>	Heavy-flavour correlations and multiplicity dependence in pp and p-Pb collisions with ALICE <i>Fabio Filippo Colamaria</i>
Event shape engineering with the ALICE detector <i>Anthony Robert Timmins</i>	Medium-effects on heavy-flavour production in large and small systems <i>Andrea Beraudo</i>

**Coffee Break**

10:50-12:30 Parallel	<b>Jets and High pT Hadrons III</b> (KFM Hall “IO”, chair: <i>Carlos Albert Salgado Lopez</i> )	<b>Correlations and Fluctuations III</b> (Exhibition Space 1-B, chair: <i>Sandra Padula</i> )
10:50	A Comprehensive Analysis of Jet Quenching via a Hybrid Strong/Weak Coupling Model for Jet-Medium Interactions <i>Daniel Pablos</i>	PHENIX results on fluctuations and Bose-Einstein correlations in Au+Au collisions from the RHIC Beam Energy Scan <i>Prakhar Garg</i>
11:10	Consistency of Perfect Fluidity and Jet Quenching in semi-Quark-Gluon Monopole Plasmas <i>Jiechen Xu</i>	Femtoscopy of identified particles in Pb-Pb collisions with ALICE at the LHC <i>Ludmila Malinina</i>
11:30	Direct-photon+hadron correlations to study parton energy loss with the STAR experiment <i>Nihar Sahoo</i>	Femtosopic measurements in p+Pb collisions at $\sqrt{s_{NN}} = 5.02$ TeV with the ATLAS detector <i>Markus Kohler</i>
11:50	PHENIX results on jet correlations via high- $p_T$ hadrons and photons <i>Ali Hanks</i>	Observable consequences of event-by-event fluctuations of HBT radii <i>Christopher Plumberg</i>
12:10	Azimuthal anisotropy of charged jet production in $\sqrt{s_{NN}} = 2.76$ TeV Pb-Pb collisions with ALICE <i>Redmer Alexander Bertens</i>	Measuring baryon-(anti-)baryon interaction cross-sections with femtoscopy in heavy-ion collisions <i>Adam Kisiel</i>
12:30-14:00	<b>Lunch</b>	

<b>Collective Dynamics II</b> (Exhibition Space 2-B, chair: <i>Chiho Nonaka</i> )	<b>Open Heavy Flavors and Strangeness IV</b> (Convention Room 1, chair: <i>Paolo Giubellino</i> )
Anisotropic hydrodynamics for conformal Gubser flow <i>Michael Strickland</i>	Heavy quark suppression and D-hadron (D-D) correlations in heavy-ion collisions <i>Shanshan Cao</i>
Decorrelation of anisotropic flow along the longitudinal direction <i>LongGang Pang</i>	Measurements of $D_s^\pm$ -meson $R_{CP}$ and $v_2$ in Au+Au collisions at $\sqrt{s_{NN}} = 200$ GeV in STAR <i>Nasim Md</i>
Hydrodynamic fluctuations and dissipation in an integrated dynamical model <i>Koichi Murase</i>	Measurements of Open Heavy Flavor Production in Semi-leptonic Channels in p+p, U+U and Au+Au Collisions at STAR <i>Xiaozhi Bai</i>
The Rapidity Density Distributions and Longitudinal Expansion Dynamics of Identified Pions from the STAR Beam Energy Scan <i>Chris Flores</i>	PHENIX results on heavy-flavor yields at forward rapidity <i>Melynda Brooks</i>
Studies on longitudinal fluctuations of anisotropy flow event planes in PbPb and pPb collisions at CMS <i>Maxime Guilbaud</i>	RAA and $v_2$ of muons from heavy-quark decays in lead-lead collisions at $\sqrt{s_{NN}} = 2.76$ TeV with the ATLAS detector <i>Alexander Milov</i>
<b>Lunch</b>	

14:00-16:20 Parallel	<b>Jets and High pT Hadrons IV</b> (KFM Hall “IO”, chair: <i>Yves Schutz</i> )	<b>Correlations and Fluctuations IV</b> (Exhibition Space 1-B, chair: <i>Fuqiang Wang</i> )
14:00	Dynamical energy loss as a novel tomographic tool of QGP at RHIC and LHC <i>Magdalena Djordjevic</i>	Magnetohydrodynamics and charged flow in non-central heavy ion collisions <i>Umut Gursoy</i>
14:20	Jet Formation and Interference in Quark Gluon Plasma <i>Jorge Casalderrey Solana</i>	Charge-dependent correlations from event-by-event anomalous hydrodynamics <i>Yuji Hirono</i>
14:40	PHENIX results on reconstructed jets in $p+p$ and heavy ion collisions <i>Arbin Timilsina</i>	The ridge and di-hadron correlations from the Beam Energy Scan at RHIC <i>Liao Song</i>
15:00	Semi-inclusive charged jet measurements in Au+Au collisions at $\sqrt{s_{NN}} = 200$ GeV with STAR <i>Peter Martin Jacobs</i>	Forward-backward multiplicity fluctuation and longitudinal harmonics in high-energy nuclear collisions <i>Peng Huo</i>
15:20	Measurement of high $p_T$ photons and neutral mesons in $pp$ and Pb-Pb collisions at mid-rapidity with ALICE <i>Astrid Morreale</i>	Measurement of two-particle pseudorapidity correlations in proton-lead and lead-lead collisions with the ATLAS detector <i>Jiangyong Jia</i>

<b>QGP in Small Systems II</b> (Exhibition Space 2-B, chair: <i>Gunther Roland</i> )	<b>Future Experimental Facilities, Upgrades, and Instrumentation</b> (Convention Room 1, chair: <i>Megumi Naruki</i> )
PHENIX results on collectivity tests in high-multiplicity $p+p$ and $p+Au$ collisions <i>Itaru Nakagawa</i>	Prospects for the dense baryonic matter research at NICA <i>Vladimir Kekelidze</i>
To Be (Collective) or Not to Be (Collective) - Different Theoretical Approaches to Describing Small Collisions System Observables <i>Jamie Nagle</i>	Studies of high density baryon matter with high intensity heavy-ion beams at J-PARC <i>Hiroyuki Sako</i>
Measurement of the long-range azimuthal correlations in pp collisions at $\sqrt{s}=13\text{TeV}$ with the ATLAS detector at the LHC <i>Mingliang Zhou</i>	Nuclear collisions at the Future Circular Collider <i>Nestor Armesto Perez</i>
Azimuthal anisotropy harmonics from long-range correlations in high multiplicity pp collisions at CMS <i>Zhenyu Chen</i>	The STAR Heavy Flavor Tracker and Upgrade Plan <i>Giacomo Contin</i>
Strangeness production as a function of charged particle multiplicity in proton-proton collisions <i>Livio Bianchi</i>	sPHENIX calorimeter design and jet performance <i>John Haggerty</i>

Tuesday, September 29<sup>th</sup> (4)

14:00-16:20 (Continued) **(Jets and High pT Hadrons IV)** **(Correlations and Fluctuations IV)**

15:40	Jet suppression and the flavor dependence of partonic energy loss with ATLAS <i>Tomas Kosek</i>	Forward-central two-particle correlations in p-Pb collisions at $\sqrt{s_{NN}} = 5.02$ TeV <i>Evgeny Kryshen</i>
-------	--	---

16:00 New results on inclusive and reaction plane dependent dijet asymmetry in Pb+Pb collisions with ATLAS  
*Dennis Vadimovich Perepelitsa*

Multiplicity and transverse momentum dependence of electric charge balance functions  
*Panos Christakoglou*

16:20-16:30 **Short Break**

16:30-18:30 **Poster Session**  
(Exhibition space 3 & 4)

19:00-20:00 **Social event: “Gagaku” play (Ancient Imperial Court Music and Dances of Japan)**  
(KFM Hall “IO”)

Tuesday, September 29<sup>th</sup> (4)

**(QGP in Small Systems II)** **(Future Experimental Facilities, Upgrades, and Instrumentation)**

Causal hydrodynamic fluctuation in Bjorken expansion <i>Kenichi Nagai</i>	Upgrade of the ALICE Inner Tracking System <i>Petra Riedler</i>
--	--

Saturation or collectivity in p+A collisions at RHIC and LHC?  
*Adam Bzdak*

The ALICE TPC: from wires to GEMs  
*Chilo Garabatos Cuadrado*

9:00-10:20 Parallel	<b>Collective Dynamics III</b> (KFM Hall “IO”, chair: <i>Boris Hippolyte</i> )	<b>Quarkonia III</b> (Exhibition Space 1-B, chair: <i>Su Houng Lee</i> )
9:00	Does non-monotonic behavior of directed flow signal the onset of deconfinement ? <i>Yasushi Nara</i>	Charmonium and bottomonium spectral functions from lattice QCD at finite temperature <i>Hiroshi Ohno</i>
9:20	Bulk evolution of heavy ion collisions in the beam energy scan: New developments and first results <i>Bjoern Schenke</i>	Spectral Functions from anisotropic Lattice QCD. <i>Maria Paola Lombardo</i>
9:40	Study of the Bulk Properties of the System Formed in Au+Au Collisions at $\sqrt{s_{NN}} = 14.5$ GeV Using the STAR Detector at RHIC <i>Vipul Bairathi</i>	Measurements of Quarkonium Polarization and Production versus Charged-Particle Multiplicity in p+p Collisions at $\sqrt{s} = 500$ GeV in the STAR experiment <i>Barbara Trzeciak</i>
10:00	Measurements of Correlations between Anisotropic Flow Harmonics in Pb-Pb Collisions in ALICE <i>You Zhou</i>	CMS Charmonia results from Run I <i>Yongsun Kim</i>

10:20-10:50 **Coffee Break**

<b>Electromagnetic Probes I</b> (Exhibition Space 2-B, chair: <i>Charles Gale</i> )	<b>Quark Matter in Astrophysics</b> (Convention Room 1, chair: <i>Bikash Sinha</i> )
Thermal photons from a modern hydrodynamical model of heavy ion collisions: status of the direct photon puzzle <i>Jean-Francois Paquet</i>	Lattice QCD for Baryon Rich Matter – Beyond Taylor Expansions <i>Atsushi Nakamura</i>
Jet fragmentation photons in ultrarelativistic heavy-ion collisions <i>Koichi Hattori</i>	QCD constraints on the equation of state for compact stars <i>Eduardo Fraga</i>
PHENIX measurements of thermal photon production in Au+Au collisions <i>Richard Petti</i>	Hot Neutron Stars with Hadron-Quark Crossover <i>Kota Masuda</i>
Direct Photons in Pb-Pb collisions with ALICE <i>Baldo Sahlmueller</i>	Phenomenological QCD equations of state for massive neutron stars <i>Toru Kojo</i>

**Coffee Break**

10:50-12:30	<b>Collective Dynamics IV</b> (KFM Hall “IO”, chair: <i>Raimond Snellings</i> )	<b>Quarkonia IV</b> (Exhibition Space 1-B, chair: <i>Jean-Paul Blaizot</i> )
10:50	PHENIX results on centrality dependence of yields and correlations in $d$ +Au collisions <i>Takao Sakaguchi</i>	$J/\psi$ and $\Upsilon$ measurements in the di-muon channel in Au+Au collisions at $\sqrt{s_{NN}} = 200$ GeV with the STAR experiment <i>Rongrong Ma</i>
11:10	Higher harmonic anisotropic flow of identified particles in Pb-Pb collisions with the ALICE detector <i>Naghmehe Mohammadi</i>	Observation of a $J/\psi$ yield enhancement at very low pT in Pb-Pb collisions at 2.76 TeV <i>Gines Martinez-Garcia</i>
11:30	Principle Component Analysis of two-particle correlations in PbPb and pPb collisions at CMS <i>Jovan Milosevic</i>	CMS bottomonia results from Run I <i>Mihee Jo</i>
11:50	Pinning down QCD-matter shear viscosity in A+A collisions via EbyE fluctuations using pQCD + saturation + hydrodynamics <i>Harri Niemi</i>	Upsilon suppression in the QGP at the LHC <i>Georg Wolschin</i>
12:10	Elliptic Anisotropy $v_2$ May Be Dominated by Particle Escape instead of Hydrodynamic Flow <i>Zi-Wei Lin</i>	Dynamical upsilon-suppression in the Schroedinger-Langevin approach <i>Pol Gossiaux</i>
12:30-18:00	<b>Excursion</b>	

<b>Electromagnetic Probes II</b> (Exhibition Space 2-B, chair: <i>Harald Appelshauser</i> )	<b>Baryon Rich QCD Matter</b> (Convention Room 1, chair: <i>Claudia Hoehne</i> )
PHENIX results on low-mass dileptons in Au+Au collisions with the Hadron Blind Detector <i>Mihael Makek</i>	Critical point search from an extended parameter space of lattice QCD at finite temperature and density <i>Shinji Ejiri</i>
System-size and energy dependences of dielectron excess invariant-mass spectra at STAR <i>Shuai Yang</i>	Real time evolution of non-Gaussian cumulants in the QCD critical regime <i>Swagato Mukherjee</i>
Low-Mass Dielectron Measurements in pp, p-Pb and Pb-Pb Collisions with ALICE <i>Patrick Simon Reichelt</i>	Estimation of the shear viscosity at finite net-baryon density from A+A collision data at $\sqrt{s_{NN}} = 7.7 - 200$ GeV <i>Iurii Karpenko</i>
Vector boson production in p+Pb and Pb+Pb collisions measured with ATLAS at the LHC <i>Iwona Grabowska-Bold</i>	Measurement of hadron suppression at 14.5GeV and study of its connection with the disappearance of other QGP signatures at low $\sqrt{s_{NN}}$ in Au+Au collisions with STAR at RHIC in BES I <i>Stephen Horvat</i>
W and Z bosons in pp, pPb and PbPb with CMS <i>Emilien Chapon</i>	PHENIX results on global observables and flow in Au+Au collisions from the RHIC Beam Energy Scan <i>Jeffery Mitchell</i>
<b>Excursion</b>	



9:00-10:30	<b>Plenary Session I</b> (Atrium plaza, chair: <i>Nu Xu</i> )
------------	--

9:00 Overview of recent ALICE results  
*Taku Gunji*

9:30 ATLAS Highlights  
*Aaron Angerami*

10:00 Overview of recent heavy-ion results from CMS  
*Byungsik Hong*

10:30-11:00 **Coffee Break**

11:00-12:30	<b>Plenary Session II</b> (Atrium plaza, chair: <i>Johanna Stachel</i> )
-------------	---

11:00 PHENIX overview  
*Axel Drees*

11:30 Overview of recent results from the STAR experiment  
*Mustafa Mustafa*

12:00 Lattice QCD : bulk and transport properties of QCD Matter  
*Claudia Ratti*

12:30-12:35 **Conference photo**

12:35-14:00 **Lunch**

14:00-16:00	<b>Plenary Session III</b> (Atrium plaza, chair: <i>Krzysztof Redlich</i> )
-------------	--

14:00 Experimental overview on flow observables in heavy ion collisions  
*Soumya Mohapatra*

14:30 Theory of collective dynamics : flow, fluctuations and correlations in heavy ion collisions  
*Gabriel Denicol*

15:00 Experimental overview on beam energy scan  
*Xiaofeng Luo*

15:30 QCD Critical Point and Related Observables  
*Marlene Nahrgang*

16:00-16:30 **Coffee Break**

16:30-18:30	<b>Plenary Session IV</b> (Atrium plaza, chair: <i>Dmitri Kharzeev</i> )
-------------	---

16:30 Heavy-ion Collisions and Cosmology  
*Stefan Floerchinger*

17:00 Femtoscopy in Relativistic Heavy Ion Collisions: An Experimental Overview at the End of the Third Decade  
*Mike Lisa*

17:30 Chiral magnetic effect in heavy-ion collisions  
*Jinfeng Liao*

18:00 Chiral magnetic effect in condensed matter systems  
*Qiang Li*

9:00-10:30	<b>Plenary Session V</b> (Atrium plaza, chair: <i>Itzhak Tserruya</i> )
9:00	Experimental overview on open heavy flavor <i>Ralf Aeverbeck</i>
9:30	Heavy quark transport and quarkonium production <i>Pengfei Zhuang</i>
10:00	Experimental overview on quarkonium production <i>Roberta Arnaldi</i>
10:30-11:00	<b>Coffee Break</b>
11:00-12:30	<b>Plenary Session VI</b> (Atrium plaza, chair: <i>Dinesh Srivastava</i> )
11:00	Initial state of the HIC: thermalization and isotropization <i>Eero Aleksi Kurkela</i>
11:30	Gravitational collapse, holography and hydrodynamics in extreme conditions <i>Paul Chesler</i>
12:00	Analytic approaches to relativistic hydrodynamics <i>Yoshitaka Hatta</i>
12:30-14:00	<b>Lunch</b>

14:00-16:00	<b>Plenary Session VII</b> (Atrium plaza, chair: <i>Barbara Krystyna Wosiek</i> )
14:00	Experimental overview on jets and high pT hadrons <i>Matthew Nguyen</i>
14:30	Theoretical Developments in pQCD energy loss mechanism <i>Yacine Mehtar-Tani</i>
15:00	Experimental overview on EM observables <i>Yosuke Watanabe</i>
15:30	Theoretical Overview on Electromagnetic radiations from QGP fluids <i>Chun Shen</i>
16:00-16:30	<b>Coffee Break</b>
16:30-18:30	<b>Special session on “QGP in small systems?”</b> (Atrium plaza, chair: <i>Jurgen Schukraft</i> )
16:30	Experimental overview on small colliding systems at RHIC <i>Paul Stankus</i>
16:50	Experimental overview on small colliding systems at LHC <i>Constantinos Loizides</i>
17:10	Hydrodynamics <i>Piotr Bozek</i>
17:30	Pre-equilibrium dynamics <i>Soeren Schlichting</i>
17:50	Summary of other reasonable theoretical ideas <i>Paul Romatschke</i>
18:10	round table discussion
20:00-22:00	<b>Conference Dinner</b> (ANA Crowne Plaza Hotel Kobe, the Ballroom (10F))

Saturday, October 3<sup>rd</sup>

9:00-10:50 **Plenary Session VIII**

(Atrium plaza, chair: *William Zajc*)

9:00 Neutron star mergers, high density EoS, and gravitational waves  
*Masaru Shibata*

9:30 Gluon saturation and EIC  
*Ernst Sichtermann*

10:00 Prospects of LHCb in heavy ion physics  
*Giulia Manca*

10:20 Future of Heavy Ion Physics  
*Shoji Nagamiya*

10:50-11:20 **Coffee Break**

11:20-12:50 **Flash talks, Awards, Next QM**  
(Atrium plaza)

## Social Events

September 27th, Sunday, 16:30 - : **Welcome Drink** on the 9th floor of the Conference Venue.

September 29th, Tuesday, 19:00 - : **"Gagaku" Play** (Ancient Imperial Court Music and Dances of Japan) on the 9th floor of the Conference Venue.

September 30th, Wednesday afternoon : **Excursion.**

October 2nd, Friday, 20:00 - : **Conference Dinner (Banquet)** on the 10th floor of ANA Crowne Plaza Hotel Kobe near Shin-Kobe Station. (Please see a map to get to the Banquet Place in the next page.)

## Excursion

In the afternoon of Wednesday, September 30th, several excursions will take place.

<http://qm2015.riken.jp/index.php?id=22>

Detail announcement (departure time, bus location) will be given during the Conference.

On-site registration will be accepted. If you would like to join the excursions, please contact JTB desk.

Several tours for the accompanied persons will be organized by JTB. Please contact JTB desk for more detailed information and registration.

# Getting to the Banquet Place

It takes 30 ~ 40 minutes from the conference venue to the banquet place using Rokko-Liner, JR line and Kobe Subway. You need to change trains twice.

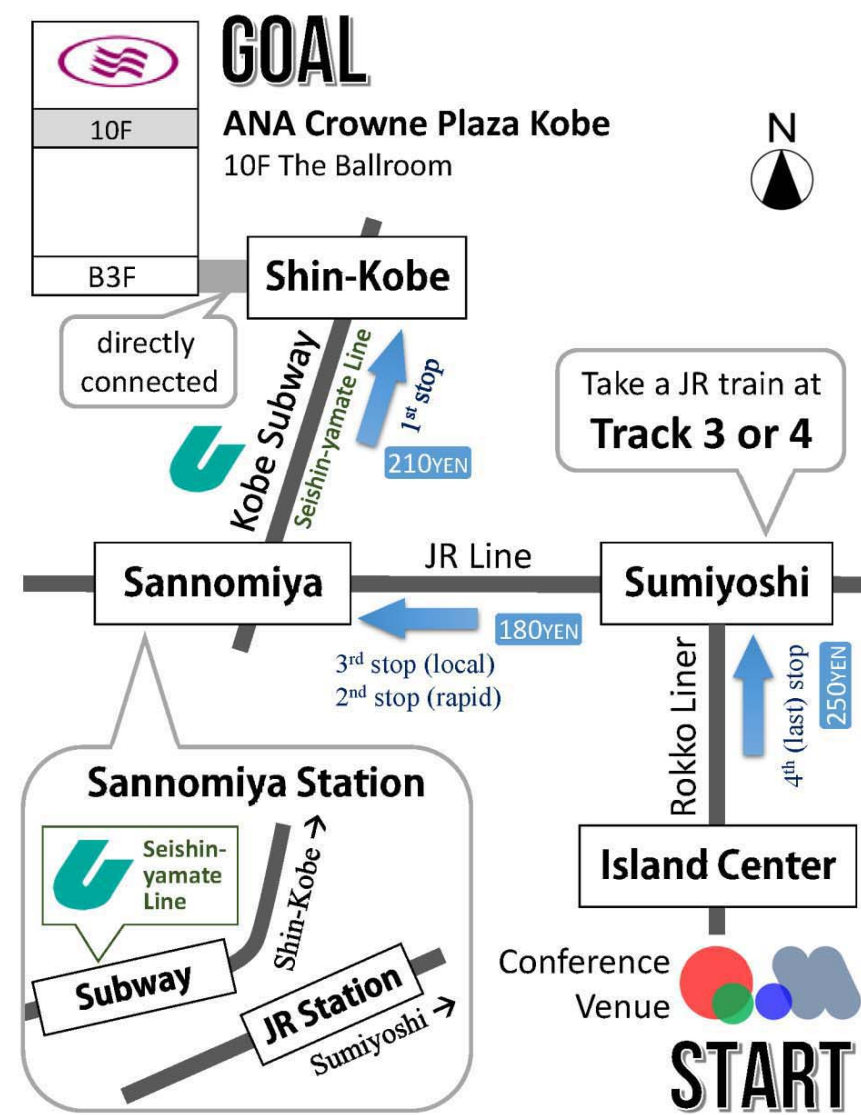

# Train from Sannomiya Station to the conference venue

When you come from Sannomiya Station to the conference venue, you need to transfer from JR (Japan Railway) line to Rokko-Liner at Sumiyoshi Station. However, special rapid service trains do not stop at Sumiyoshi Station. Please check a time table to get on **local** or **rapid service trains** at Sannomiya Station.

Time table of trains from Sannomiya station (三ノ宮) to Sumiyoshi (住吉), Monday - Friday. (Track 1 or 2 in Sannomiya Station.)

7am	[普通] 京 03	[快速] 米 08	[新快] 野 11	[普通] 四 14	[普通] 手 19	[快速] 野 23	[新快] 敦米 23
	[新快] 野 29	[普通] 横 29	[快速] 塩 30	[普通] 手 34	[新快] 草 38	[普通] 京 38	[快速] 大 39
	[新快] 野 47	[普通] 横 47	[快速] 野 48	[普通] 四 51	[新快] 浜 55	[普通] 京 55	[快速] 大 57
8am	[普通] 横 00	[新快] 野 04	[普通] 放 04	[快速] 米 05	[普通] 尾 08	[新快] 野 13	[普通] 横 13
	[普通] 横 17	[新快] 今 21	[普通] 尾 21	[快速] 米 23	[普通] 放 26	[新快] 浜 30	[普通] 京 30
	[普通] 横 34	[新快] 野 40	[普通] 京 40	[快速] 野 40	[普通] 放 44	[快速] 大 44	[普通] 尾 51
	[快速] 米 56						[新快] 敦 51

[普通] = Local Train -> OK  
[快速] = Rapid Service Train -> OK  
[新快] = Special Rapid Service Train -> NG

## Hotel Map

Main hotels for QM2015 participants are shown in a following map. Kobe Fashion Mart is the conference venue. Lunch is served at ① **Kobe Bay Sheraton Hotel & Towers**. The conference dinner (Banquet) place is ⑧ **ANA Crowne Plaza Hotel Kobe**.

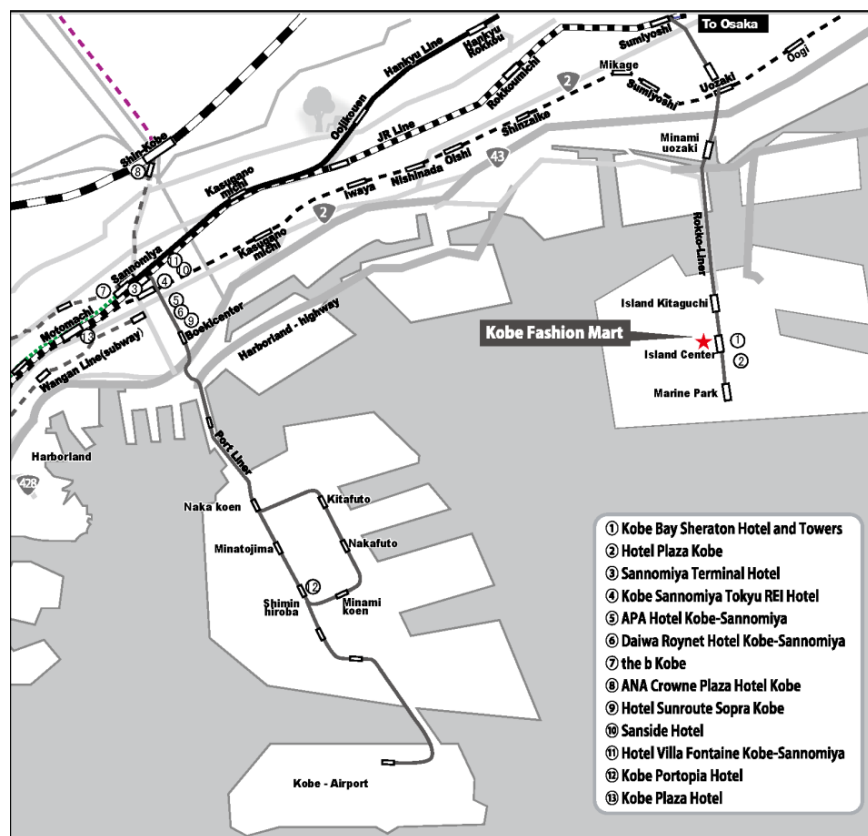

## Lunch

Lunch is served at 4 halls, **Rokko Ballroom, Ocean, Kitano** and **Island** at **Kobe Bay Sheraton Hotel & Towers**. Please bring your name tag to the halls. **Vegetarian and any special meals** are served **only at Ocean Hall**.

How to get to Lunch Halls: The hotel is located on the east side of the railway station. Take the escalator to the 2nd floor (2F) and exit the building. You can reach the hotel entrance through a walkway across the railway in one minute.

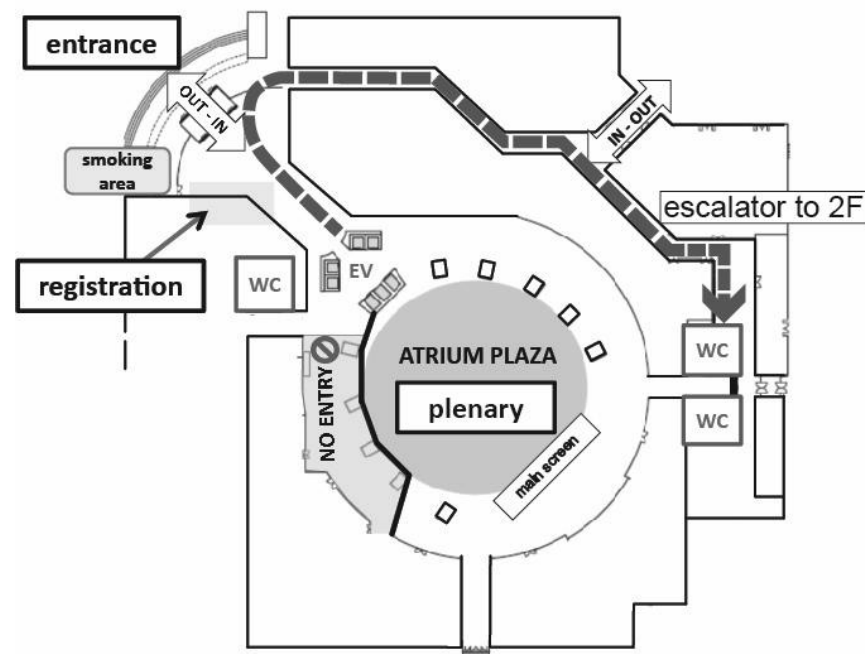

A floor map on 1F of the conference venue

Wednesday, September 30th: Box lunches are provided at the cafeteria on 9th floor of the conference venue. Please make sure to take it before getting on a bus, if you join an excursion.

## Hospital / Clinic / Pharmacy

In case of the medical emergency, please contact the local organizers at the conference office.

There are some hospitals, clinics and pharmacies near the conference venue (Kobe Fashion Mart).

## ATM

Japan Post Bank in front of the conference venue and Seven-Bank in Seven-Eleven stores may accept your international brand credit, debit, prepaid and cash cards such as VISA, MasterCard, 中国银联, American Express, JCB, Discover and Diners Club. Business hours of Japan Post Bank (ATMs) are 9:00 - 19:00 on Saturday, 9:00 - 19:00 on Sunday and 8:00 - 20:00 on the other days. Seven-Eleven Stores are open for 24 hours.

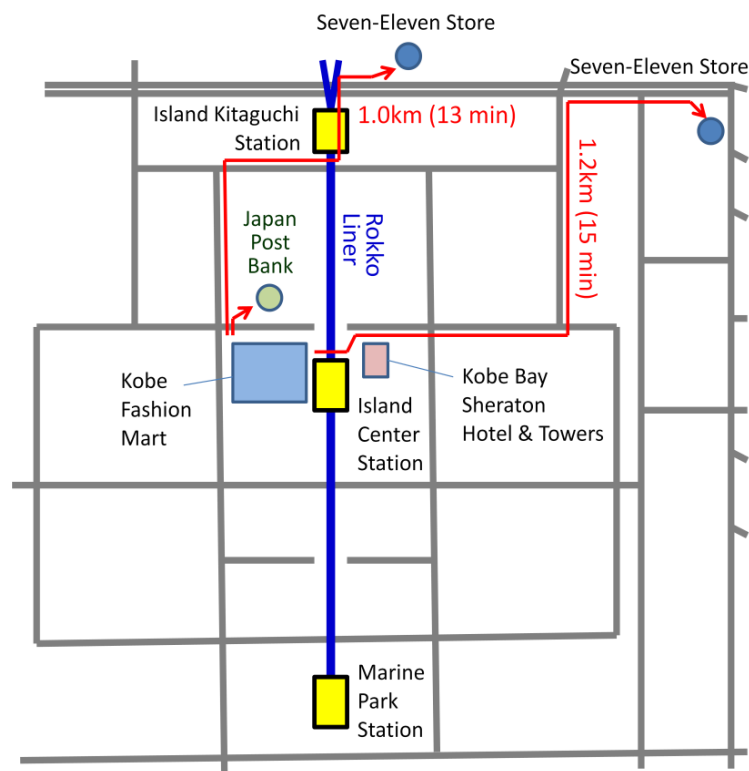

## Financial Supporters

Financial support by laboratories, institutes, and universities, and donations by companies.

